

UNIT 10
FIRST FLOOR PLAN

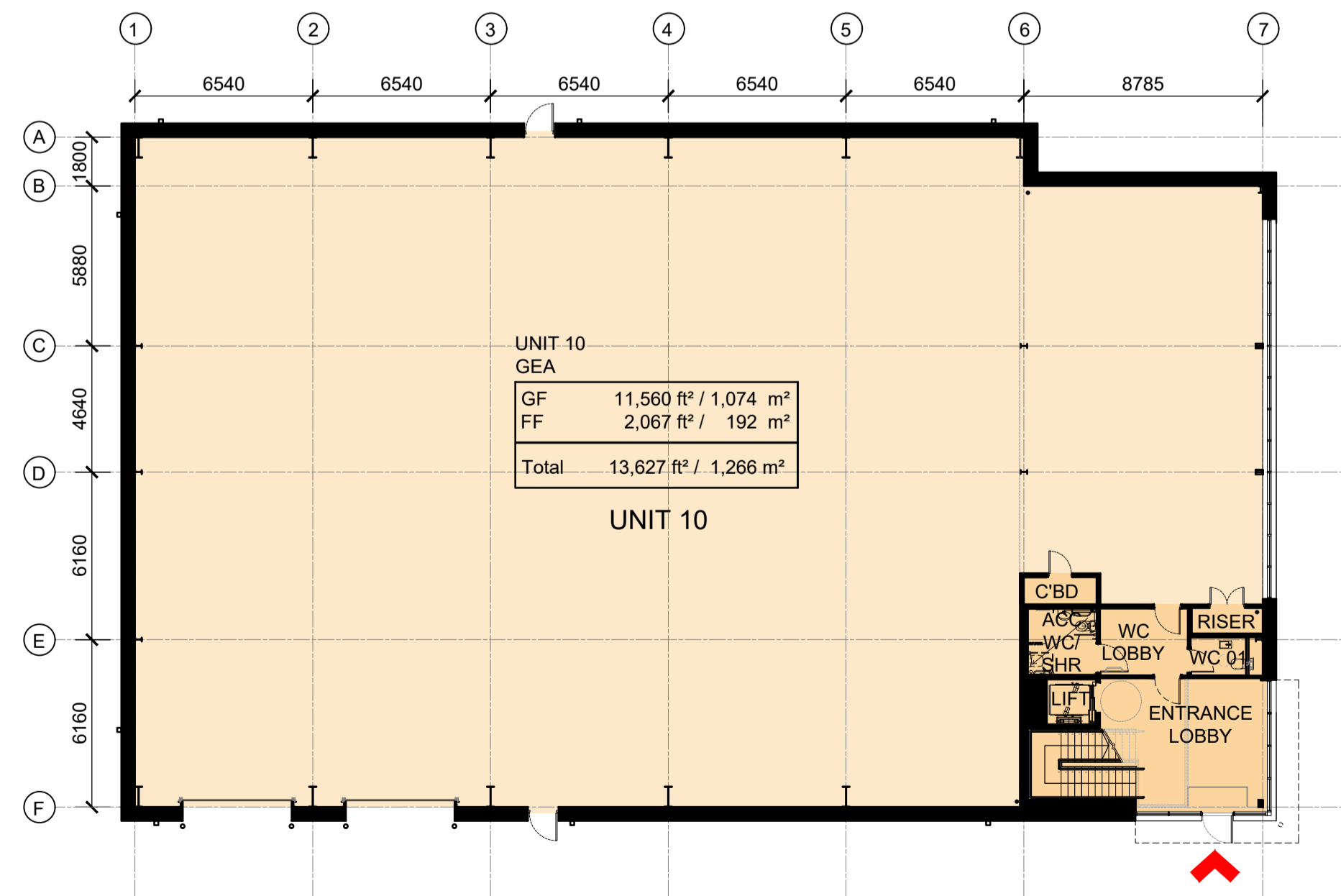

UNIT 10
GROUND FLOOR PLAN

Client:
HE2 READING 1 GP LTD (LONDON)



Project:
HEADLEY ROAD EAST
WOODLEY

12 Warren Yard,
Warren Park,
Milton Keynes,
MK12 5HW
01908 305 246

info@prc-group.com
www.prc-group.com

Drawing Title:
UNIT 10
PROPOSED FLOOR PLANS

Scale @ A1: 1:200
Checked by: JR
Date: SEPT 21

Job No: 11359
Stage: PL 114
Drawing No: PL 114

Issue Status:
Construction Preliminary
Information Approval
Tender

Architecture
Planning
Master Planning
Urban Design
Interiors
Landscape
Offices
Woking
London
Milton Keynes
Warsaw

This page is intentionally left blank